

RawHide Gazette

Copyright © 1999 by PSLAC, All Rights Reserved

"Without question, the RawHide Gazette is by far the best and most informative and comprehensive Guild publications of all of them! You are to be commended for your very fine and professional efforts. Keep up the good work. With admiration"
/signed/

Al & Ann Stohlman, December 1997

Volume 5, Issue 4

Puget Sound Leather Artisans Co-Op

June 1999

Hide Highlights

- LC&SJ Articles?
- Tips-Tips-Tips
 - The Screw Punch
 - Snap Setter Die
- A Visit with Ann Stohlman
- Project -- Leather Tissue Packet Cover
- From the Dusty Workbench -- Butterfly
- PSLAC Donation from Tandy
- May Meeting Pictures
- Uncle Bill's Corner
- Ken's Knothole

Mark your calendar!

The next meeting will be:
Sunday, June 27th,
2:00-4:00pm
Location: At MacPhersons
Leather
(see back for map/directions)

LC&SJ Article Suggestion

The RawHide Gazette produces many fine articles from many people. A lady, on the Internet, recently asked: "Why doesn't the *Leather Crafter & Saddlemans Journal* reprint our RawHide Gazette articles"? The answer is simple -- We don't submit the articles to the LC&SJ for publication.

This comment got me thinking (yes, I know it is dangerous for me) that those of you who submit articles to the RawHide Gazette might like them and their associated photographs be submitted to the LC&SJ. Since the LC&SJ has recently obtained an email address, that would be quite simple for me to forward a finished RawHide Gazette article to the LC&SJ. Or for that fact, you could submit an article, tip directly to the LC&SJ either via email:

journal@newnorth.net

...or via US Postal mail:

LC&SJ
331 Annett Ct.
Rhineland, WI 54501-2902

With the demise of the local Tandy Retail Stores, there are fewer walk in locations for the LC&SJ to be sold and fewer newer leather crafters to find out about it. Supporting the LC&SJ would help keep the

Dusty & Rick at the Potluck



LC&SJ fresh and new as the RawHide Gazette.

Bob Stelmack
Hamamatsu, Japan

Tips-Tips-Tips

The Screw Punch

On my latest "hunt" in the Hamamatsu Leather Craft Store, I located a unique leather punch. I was looking for that standard 5 or 6 punch unit that has a wheel of punches and a small anvil that punches by squeezing the handles together. What I found instead, was a wooden handled punch that when pushed into the leather caused the cutting bit to rotate as it was pushed. This new tool made very clean holes without that heavy beveled edge formed by pounding a punch through the leather.

Snap Setter Die

I am forever losing that small concave die used to set the domed snaps. Must have bought a dozen over the years. Again, while making some snaps to hold items on my new bike I couldn't find that damn die, so (don't tell Karen) I looked in the kitchen and grabbed one of the silverware teaspoons and moved the snap around til I found a spot that matched the contour of the snap and set it right there on the cutting board. It worked perfectly.

Now that I think about it, I do keep a teaspoon in my leather tool box. I use it for, guess what? -- a modeling spoon to work larger areas.

Bob Stelmack

Hamamatsu, Japan

Scaly Skin

Use your "V" groover to cut snake skin scales. It makes scales the most resemble rattle-snake skin.

Bob Stelmack

Hamamatsu, Japan

Dusty -- On the Way to Retirement

Tandy had wonderful customers and some of them stand out from the crowd. Ernie is one of them. The first time I met him, and as he was leaving he said: "Abeseeingya". I asked the manager: "What is he saying"?

He told me to sound it out. I did and came up with "I'll be seeing you". The next time he came in I asked him what his name was, he took a deep breath and said "Ernest Lamar Walter Oswald Nicodemus Percyville Chancy Fernando" and then he stopped looked around and said he couldn't remember his last name. I said: "Smith or Jones"? and he replied: "That's it — Smith".

He would come in with his wife and she laughed right along with everyone when he said his names. I would look forward to their visits every week. They stopped coming in for awhile and when he finally did come in — he was alone. I of course asked where is the wife? He said that she hurt her hip, so she wouldn't be coming in for a while. I wrote on the receipt "Get Well Soon" then I asked "what is your wife's name"? He thought about it and then said "I better go home and ask her I always say 'Hey You' and she answers." The next

Leather Factory Spokane

28 West Boone Ave, Spokane, WA 99201

Phone: (509) 328-9939

Toll Free: 1-800-822-8437

Fax: (509) 326-7019

Offering a wholesale discount to the PSLAC members

<http://www.flash.net/~lfmidas2/index.html>

Kevin White, Manager



receipt I started my note to her with "Dear, Hey You". I still call her Hey You and I found out that from that time on her nickname is Hey You. Hardly ever is she called by her real name "Gladys".

Whenever Ernie came in and I had lots of customers I could count on Ernie to entertain them by asking him to tell everybody his name. He would give all of his names and then like always he would say that he couldn't remember his last name I would

RawHide Gazette

Editor / Publisher: Bob Stelmack
Co-Founder: Bill Churchill
Co-Founder: General Seymour
Treasurer/Secretary: Linda Stockhausen

Copyright © 1999 PSLAC, Puget Sound Leather Artisans Co-Op

The RawHide Gazette is published monthly (12 times a year). Address for information and correspondence: PSLAC, c/o Bill Churchill (ph. 253-839-3038) 1471 South 302nd, Federal Way, WA 98003 (email: churchil@nwlink.com). The RawHide Gazette is provided to the Puget Sound Leather Artisans Co-Op as a part of their membership benefits. Annual dues are \$24.00 USD per year.

All submissions are subject to editing for clarity and length. All articles submitted must be accompanied by name and address of writer.

POSTMASTER: Send address changes to PSLAC, c/o Bill Churchill, 1471 South 302nd, Federal Way, WA 98003

Advertising Rates

The RawHide Gazette now offers advertising space to interested parties. Ad spaces are as follows:

1/4 Page or Business Card \$60 USD
1.2 Page \$110 USD
1 Page \$200 USD

These rates cover a six month time period. Guild members are entitled to a 25% discount. Leather companies supporting PSLAC are given free Business Card size advertisement, additional space at regular rates.



TWLeather, Inc.

Toll Free:

1-800-477-9923

2017A White Settlement Rd.

Fort Worth, TX 76107

(817) 877-5427, Fax (817) 877-5432

Email: TWLeather@AOL.com

Offering a wholesale discount to the PSLAC members

Jim, Ken & Cal, Managers

answer "Smith" and he would say: "Oh that's right — Smith". When he got to the Smith part there was a squeal of delight and a lady said "Well I'm Mrs. Jones pleased to meet you Mr. Smith". As she was leaving, she said: "Good-by Mr. Smith, pleased to meet you" and Ernie replied "Oh yes, Mrs. Jones, it was my pleasure".

I've learned from the many Smith's that I've had the pleasure of meeting that everyone starts out named Smith and if they do anything wrong they have to change their name.

I really have learned to love Ernie and Hey You and we visit them often at the Retire-

ment Home.

Abeseingya,
Dusty

A Visit with Ann Stohlman

Last night (June 13, 1999) at the stroke of midnight, we returned from a wonderful visit with **Ann Stohlman**. Chuck who works for a Canadian company, had to go to British Columbia on business, and he asked General and I if we would like to ride up with him. Naturally a visit to Ann's was in the offing. So I called her and she said come ahead.

First the trip. The three of us were in the front seat of Chuck's pickup and if you have never been from Vancouver to (Ashcroft) Cache Creek, along Canadian Highway-1, you have missed some very beautiful country. Speaking of missing: Chuck has really missed his calling in this world. He should be revving up some car at the Indy 500 mile speedway. General (and I quote) "Chuck those signs that say slow down to 50 KM (approximately 32 MPH) means slow down because these curves are dangerous!" "What signs..??" Anyhow, we did make it, but it will probably take a lot of work to get the DEEP finger impressions out of the arm rests. The weather was beautiful and the traffic was nice (except on the curves).

We told Ann that we would be there by 11:30 and we were an hour late so there went lunch (even with the '100 MPH curves). Ann is now living in a condo, nothing like the Cabin at Cache Creek when I first met her in 1984, and she was just as gracious as she has always been. Her first words, "Now I can put a face on two more names that I have read about in the Gazette, General and Chuck." Speaking of the Gazette, she does show the Gazette to her Leather working friends in

Canada and she did have some good suggestions. **NOT ENOUGH** different people putting "How To" articles in each month.

Ann looked extremely well and content. She has a beautiful view of the Thompson River and even though she now lives in a community, the animals come to her door. A mother Marmot and her baby were curious about the three strangers at their friend's house.

When Ann moved to Ashcroft (BC) she brought all of the Stohlman Carvings with

Ann taught Al to fish and he taught her leather. Both were excellent teachers, but Ann told us something that we all thought was very interesting. When Al was teaching Ann leather carving, he refused to teach her the use of a camouflage and veiner tools. He said that the basic floral carving was not realistic enough.

Ann sends her Greetings to All the members of PSLAC.

Bill Churchill,
Federal Way WA



her. She was nice enough to show them to us. Words are not enough to express the majesty of these carvings. Pictures of the carvings would not show just how beautiful, and the Imagination that went into all of the carvings is breathtaking. Purses, belts, credit card cases, pictures, plaques, and my favorites the Cards that Al made for Ann. (eg. Birthday, Christmas cards, etc.) For instance one — Ann taught Al to fish (fly fish) and when you open the card there is Al with a fly fish hook in his ear but when you look closer, there is a fishing line from the fly to the next page and as you open the card, the line pulls the fishing rod in Ann's hand and bends it just like a real fishing rod.

Special Deal for PSLAC

Brettun's Village, Churchill Barton, Brettun's Village Shops, 302 Lake Street, Auburn, ME 04210 (207) 782-0861 Offering a 10% discount to PSLAC members and will also throw in a free bonus item (our choice) in each PSLAC member order. We recently added buckles, rivets, grommets, and loads of other stuff (excess inventory from local manufacturers) to our shop. <http://w3.ime.net/~barton>



glued. Remember to measure in from finished edges to center your pattern.

I believe that U.S. tissue packets are a little larger than the Japanese packets. Check dimensions and adjust the pattern accordingly.

Try Ohio Bag for the decorative end pieces. I do not know what to call them -- end clamps, maybe?

Leather Tissue Packet Cover

In Japan, you cannot pass a busy city street corner without being offered a small, complimentary package of tissue—complete with advertisements. These tissues come in handy, since most rest room do not have paper towels to dry your hands and many toilets are infrequently stocked with toilet tissue. Our friend, **Miesaji-san**, owner of the **Hamamatsu Leather Craft Store**, devised a leather kit to hold these packets of tissue. This looks like a money maker for the craft shows. The following are directions to produce a tissue pack holder for tissues handed out in Japan – alter the measurements to fit the common tissue packets in your area.

Great idea for the craft shows.

- 1 Cut a piece of bonded vinyl, bonded leather, or 2 oz. tooling leather 18.5 cm by 13 cm.

- 2 Mark in 2 cm from each 13 cm end, and mark center of 18.5 cm edge.
- 3 Apply contact cement to the marked 2 cm areas. Smooth it out with a flat stick, small spatula or palette knife. Allow to dry until tacky, then fold edges in half so there is a 1 cm “hem”. Use roller to compress glued edge.
- 4 Apply contact cement to each 18.5 cm edge, spread to a depth of approximately .5 cm. Allow to dry until tacky, then fold each end to the center mark. Use roller to compress glued edges.
- 5 Put the decorative metal edging on each end and clamp tightly with the clamp. You will get the best results by applying moderate pressure first all the way across the end, then going back and increasing pressure until the edging is gripping the ends tightly.
- 6 Insert a packet of tissue.

If you want to get fancy and do a stamped or tooled leather cover, do the stamping/tooling first, then skive the edges to be

Ohio Travel Bag Co.

6481 Davis Industrial Parkway
Solon, OH 44139
Ph. 800-800-1941

If you cannot locate the end clamps -- then either lace or hand stitch the two ends.

The following page gives a step-by-step pictorial sample of the tissue holder's construction. Good luck and give it a try!

Karen Stelmack
Hamamatsu, Japan



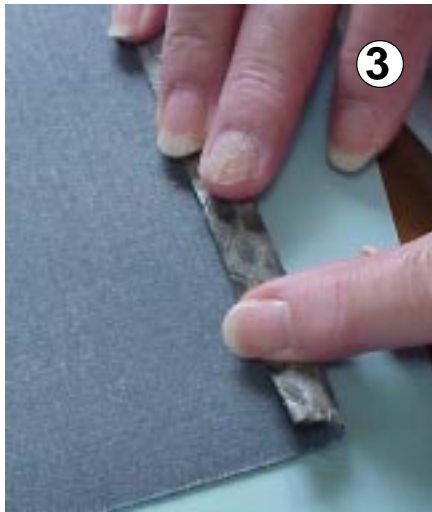

PSLAC Donation from Tandy

The CO-OP just received 15 boxes of "LEFTOVERS" from the now closed Tacoma Tandy. There are a few strings attached:

First and foremost my wife advised me with a glint in her eye: *"That 'stuff' will be out of here by the next meeting"*.

Second, we owe a great deal to **Dusty Wert** and **Linda Stockhausen** (not to mention their husbands who packed and carried all of it) and I think that a letter of appreciation from the CO-OP is definitely in order. Also, a Letter to Tandy wouldn't hurt either. In fact, I think it is necessary.

Curiosity got the best of me. I looked in the boxes --books., rivets, tools, kits, snaps, hardware, horsehair, wooden mallets, patterns and more BOOKS. Where PSLAC stores it, my wife doesn't care. But I would suggest that all of it is inventoried along with all of the other stuff that The CO-OP owns. The sooner the better.

Bill Churchill,
Federal Way, Wa

Portland The Leather Factory -- Grand Opening

I know a bunch of you were interested in the **Portland Leather Factory's Grand Opening**, so I just wanted to send an update.

The dates are **June 23 - June 26**. Hours are **9:00 - 6:00 weekdays and 10:00 - 4:00 Saturday**. I should have flyers to send out to those who have requested one around the first of next week. Called in orders are just fine - the number is 888-277-3360 - but



we'd love to meet you in person if you can be in the area.

We have some special guests scheduled to appear, also.

Ellis Barnes from Gomph-Hackbarth Tools (the best stamping tools to be found), **Ferd from Ferdco** will be here with new and used stitchers, **Debra Williamson from Salz Tannery** (Latigo and oilies), **Bill Reis from Leather Crafters Journal** (he's trying to convince Dot to come, too), and we're working on **Ron Edmonds from Ron's Tools**.

Hope to see some of you here!

Susan Hefta <HEFTA@sprintmail.com>

Thanks to PSLAC

(Ed. Note: An email letter sent to Bill Churchill)

I can't thank you (Bill) enough for co-founding the PSLAC. Guild participation in this area (LOS ANGELES) is almost nil. I joined the Leathercraft Guild, about 4 months ago and it is unusual to have more than 10 members present at a meeting.

The PSLAC has a great newsletter and the questions that I have addressed to members have always come back with good information.

I almost wish I lived in the area, but being a native So. Californian - I think of snow as something that looks good on the mountains, as you are setting on the beach, with a cold drink in your hand.

I am going to be in your part of the

country in late July-August. I was sorry to see that you don't hold meetings during the summer. Could you direct me to any worthwhile leather sites in the N.W. Stores etc? I will be driving and photographing all over the Oregon-Washington area during my trip.

I am also looking for an old Al Shelton book and pattern pack called "OPERATION LEATHER" put out in the late 50's early 60's, it was a how to of floral design and technique. This is not the 80's Tandy operation leather program. I would like to get a copy of this book or even just a photo-copy of it. If you know of any copy I would appreciate knowing about it.

P.S. By the way I purchased some materials from Hidecrafters last week - received them in 3 days - and got a 25% discount - what a deal.

Mark Effle <midway1cas@hotmail.com>

From the DUSTY Workbench

Butterfly

If it looks like a butterfly, flies like a butterfly it must be a butterfly. It looks like a butterfly flew into my house today but in what really happened it was a gift from a customer some years ago.

I've enjoyed it for many years and every time I see it I think of the lady who made it and her family. Her kids are the real winners of the leather project. The reason I think that, is they did the research that went into each butterfly. They drew out the different butterflies and learned where and how they live. Then they all cut out the thin leather in to the shape of the butterfly they had studied. It was not tooled just painted on both sides exactly like the real butterfly looked.

I felt the excitement of the kids when they let me pick the butterfly of my choice. They told me all about the butterfly that I choose and I could tell that they had really done their homework.

I don't have any young kids around my home, but if you do and you want them to learn and have fun doing it, try this technique.

They made the butterfly into pin. I think it was really a good idea.

You don't have to do butterflies, but any

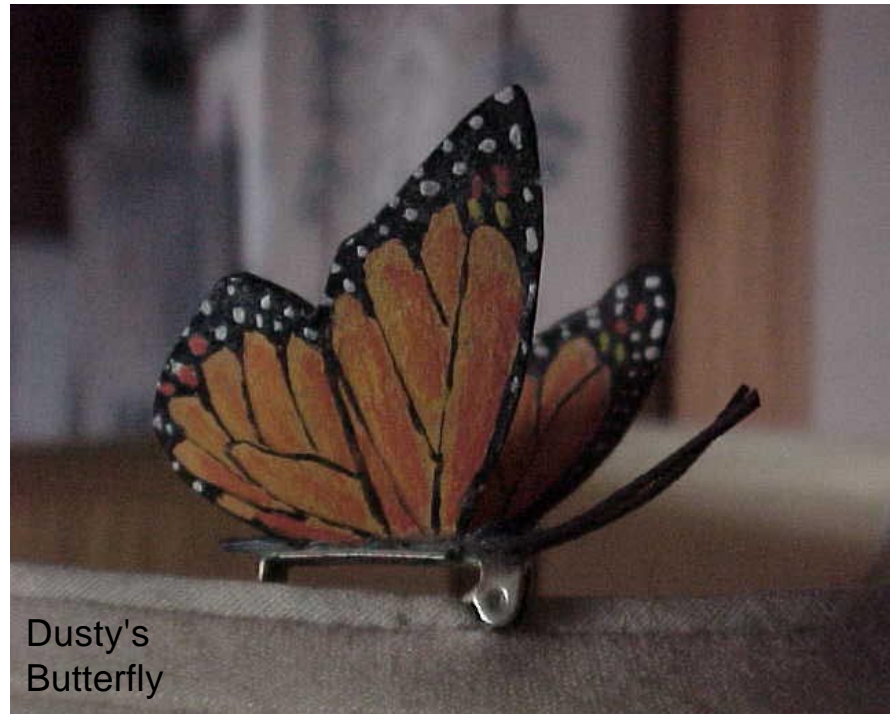

subject pretty much will work. Flowers, trees, or maybe Dinosaurs. I bet you can think of a lot of different things too.

Dusty Wert



Uncle Bill's Corner

Boy does time pass by when you are having fun and I feel sorry for those that missed the Annual POTLUCK. It was fun — Alka Seltzers and all. The meeting was one of the best that we have ever had. At least 50 people were there (including the PSLAC Mascot “TIKI”) and naturally what made the meeting even better was that the Stelmacks’ were there. They were on their



R&R from the land of the Rising Sun. They didn't eat too much because we had no Fish Heads or Rice. They were not used to all of this good food. Just kidding Karen — I know you do the cooking over there. Believe me, the Potluck was GOOD. Rich and Chuck have missed their calling — Burger King is looking for a few good men. I get hungry just thinking about it.

I would talk about the raffle, but the same people always win — no matter what hat and who does the drawing. Was quite the raffle though. There were two Japanese books on Leather donated by the Stelmacks'. One on leather dolls and one on carving castles around the world. Couldn't tread a word, but the leatherwork was something to talk about. Other Items were raffled, but I didn't get to win a thing. Phil O'Neil did let me carry the director's chair he won home to hold for him.

We showed a conversation with **Ann and Al Stohlman and George Hurst** on our NEW TV/VCR. At our September meeting we will show a video made from one of Tandy's old 16mm films. “Al Stohlman

carving the Famous Horse head and then Dyeing it”. This is a classic and there aren't too many of these videos out there, so don't miss out.

Earth Shaking News — WE NOW HAVE OVER THREE HUNDRED (300) MEMBERS. All of you leather companies. pay attention. We are picking up about three or four members a week.

I just received the June Newsletter from the **Lone Star Guild**. I would like to quote a few lines written by their new president, Andy Stasiak, a PSLAC Charter Member:

“With the disappearance of Tandy Leather from all these cities we have lost a valuable resource in promoting our craft. If the craft is to stay alive and

prosper, we need someone or some group to pick up the torch and do the promoting — Who better than the Leather Craft Guilds? We as individuals and as a group can go to the schools and other youth groups and introduce these people to the craft. How about the county and state fairs, arts and crafts festivals? These events can be a lot of fun and very profitable for your Guild. I personally know of several Guild Members who are teaching leathercraft class in their own homes. They are making a few bucks and enjoying the heck out of it. There are many ways to promote the craft. We can make it happen — in fact, we must make it happen. I challenge all Guild Members to introduce the craft to at least one new person in the next 60 days, and bring that person to the next Guild meeting. Or maybe you would

rather do a demonstration at a local school, the county or state fair or at a youth group meeting. Whatever you do, remember, it is up to us to promote and keep our craft alive and growing.”

Mr. Stasiak, I couldn't have said it better. This is what it is all about. Thank goodness for **P.K. Dan** and all who promised to help her this fall. We have a new meeting place. It has room, lots of room, chairs and tables and a place for the kids to learn while we are having the “grown-up” meeting. The CO-OP has purchased and has been donated about 250 to 300 Leather Carving Instruction books. We have some tools and mallets and boards and always looking for more and we have also purchased quite a few group packs for the kids to work on. Additionally, **Brettun's Village** has donated leather for the kids. Others have donated a lot of remnants, so it won't be too hard for us to start the fall off with a bang.

Now on to my “Other Crusade”: **IT IS PUYALLUP FAIR TIME!** Bring your projects to the June meeting. General and I will take them and enter them for you. If you can't make that, bring or mail them to me, and **General** and I will enter them for you. A map and a release form will be in the July **Rawhide Gazette**. You have to



Toll Free Order Lines Tel:
1-(888) 263-5277
Fax: 1-(888) 263-5086

Hide Crafter Productions

Offering a 25% discount (10 % on leather) to the PSLAC members
ON-LINE CATALOG <http://www.nwlink.com/~stelmack/hurst>

2017 B White Settlement Road
Ft. Worth, TX 76107

email:
hCrafter@flash.net Manager

have this otherwise the fair will not accept the projects from **General** and I. If you bring your projects to the June meeting I will have a release and information form for you to fill out. See you in June.

Bill Churchill
Federal Way, WA



May's Meeting Pictures

Thanks to **Woody's** arrangement of the May Meeting at the **White River Mobile Estates**-- we had quite a large area to have our annual pot luck meeting. Many people brought their recent and even some old projects to share with others. Here is just a sample of what was there to see.

See how many you can identify with the leather artist.



Betty's Best of Show

Betty brought her recent project and its trophy. This deer skin outfit, with its bead and feather trimmings won the 1999 Employees Community Fund Art Show -- "Best of Show".



Ken's Knothole

I think Bill pretty much said it all this month. Had a great meeting/potluck/barbecue. Great food and good to be able to share it with so many members, especially Bob and Karen Stelmack, back visiting from the Land of the Rising Sun. Bob brought some Japanese leather working books for the raffle that we were all drooling over and between those, Bill's tent, and a folding chair we had an interesting raffle. Members brought lots of really well done leatherwork for display.

Bill reminded us about getting our items ready to submit to the **Puyallup Fair**. Bill and General will collect at the June meeting (last meeting before summer break) or you'll need to arrange to get to Bill at his house (call him first). He and General will take down and pick up for us, but we need to sign off on a sheet that allows them to do that, or the Fair will not accept them. It's a real treat to go the Fair and see people admiring and talking about items that you made.



Along those same lines, Betty talked about collecting items for display at the **King County Fair**, in July. She volunteered to pick up items at the June meeting and take them to this fair and pick them up after. Lots of 4H kids attend this fair. We also talked about Fred's idea of having a traveling display that we could take to **Libraries and Community Centers** in the Puget Sound

area. There was some discussion of the Coop paying for materials if one of the more talented wood workers in the group wanted to take on the project of making folding display case(s). Finally there was a lively discussion regarding encouraging kids to learn how much fun leatherworking can be, and maybe approaching some of the **Boys and Girl Scout groups** to “test the waters”. We can get the starter kits and we have the knowledge to impart, now we have to “find” the kids. PK has indicated that she willing to be a focal, to work on this further, but is looking for LOTS of help from the members.

On a personal note, I’m trying not to let a new computer at home swallow up all my free time and keep me from working on my latest passion, braiding. So far I’ve tried a 6 part, 10 part, 13 part and 16 part flat braid, a crocodile ridge braid and a 6 part - 5 bite Turk’s head knot, with varying success. I took several projects into Dave Morgan’s, our friendly neighborhood whip and hat-band maker (and importer of Kangaroo hides). He gently said, “these are good, but let me show you what you’re doing wrong”.

He then proceeds to make it look exactly how it is in the book. Nice to get tips from an expert. *Which leads me to one of our own experts, and the hands on demo that Chuck Carlson is doing on braiding for the June meeting (limber up your fingers).*

June Meeting: June 27, 1999, at 2:00pm at



McPherson’s Leather Co., 519 12th Ave., Seattle. They are east of I-5, one block south of Jackson. If you get off I-5 at James and go up the hill (away from downtown) to Boron, right, about 4 or 5 blocks right onto 12th, past Jackson, they’re on the right (west) side on 12th.

Parking is on the street, but on Sunday it

shouldn’t be too bad.

Terry Durbin, the manager is looking forward to our visit. *He’s going to be looking for input on what we’d like him to stock in the way of craft items.* See you there.

Ken Ericksen



Fred's Belt Buckle Holder



Fred Nachbar brought his Leather Belt Buckle Holder, to the May Meeting, that has been featured in the LC&SJ. The top buckle, of the eagle, is the buckle that Fred uses in his Leather Coloring Class. The eagle is used to show several techniques in coloring leather. To contact Fred for the next scheduled class call or write to:

Fred Nachbar
P.O. Box 742
Port Orchard, WA 98366
ph. (360) 874-6624



Quick Pencil Holder from scrap 7/8 oz. leather -- just punch, wet form and rivet together.

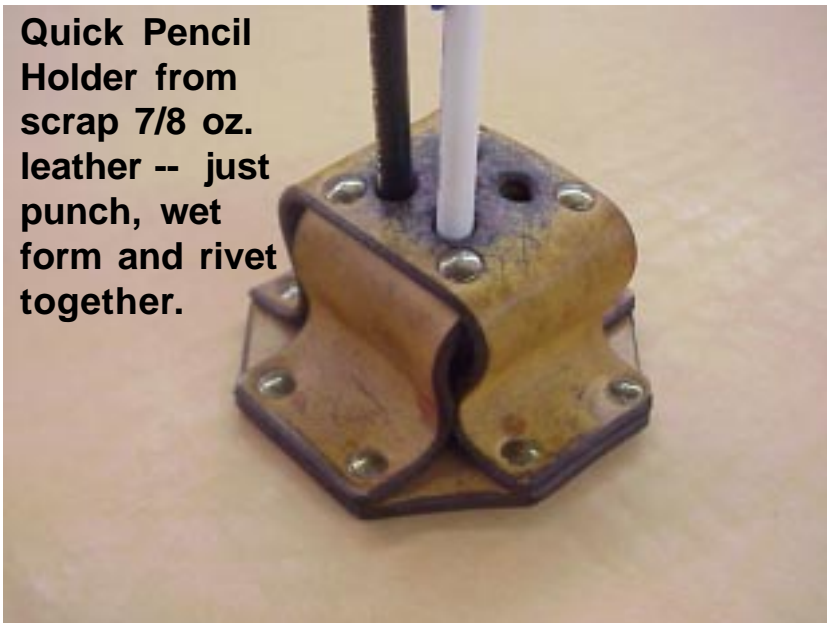



Is PSLAC a Leather Club or Camera Club?

Here is "just a sample" of the high powered cameras that show up at the meetings. Be sure to bring your camera to capture new project ideas from other peoples projects.

PSLAC Membership Application

If you know someone who is interested in leathercraft — give them this information:
Puget Sound Leather Artisan Co-Op MEMBERSHIP APPLICATION

YOUR NAME: _____

STREET ADDRESS: _____

CITY, STATE, ZIP: _____

PHONE NUMBER: (____) - _____

We publish a membership list with our members expertise listed. This list is used to refer possible clients to the best person for the job. Tell a little about yourself, how you got started in leather, what your favorite things to do in leather and other crafts and/or art forms

Send this form along with your first years dues (\$24.00) to one of the directors listed below:

Bill Churchill
1471 South 302nd
Federal Way, WA 98003
(206) 839-3038

Chuck Carlson
18117 - 103rd St. East
Bonney Lake, Wa 98390

Linda Stockhausen
12614 142nd.Ave. Ct, E
Puyallup, Wa. 98374
(360)770-8751

If you would like to subscribe to The Leather Crafters & Saddlers Journal through the Co-Op and include an additional \$24.00 for a one year subscription.

RG On-line

The Puget Sound Leather Artisans Co-Op can be found at

<http://www.nwlink.com/~stelmack/pslac.htm>

If you need the **UserId** and **Password** for the subscription pages, just contact the **Rawhide Gazette** at: (253)839-3038 or email at churchil@nwlink.com ...or...

stelmack@nwlink.com -- of course the password information is free for the Puget Sound Leather Artisans Co-Op members. Those on the Internet still need the \$10 per year subscription rate.

Web Editor: Bob Stelmack
Sanaruko Parktown South #1101
Tomitsuka-Cho 1933-1
Hamamatsu-Shi 432-8002
Japan

Your Photos here -- if you send them in to:

PSLAC (ph. 253-839-3038)
c/o Bill Churchill
1471 South 302nd
Federal Way, WA 98003

Photos taken and sent in to the PSLAC are, space and focus permitting, used here in the printed newsletter.

They are also posted, in living color, on the Internet.

June Meeting:

June 27, 1999

at 2:00pm

at McPherson's Leather Co.

519 12th Ave., Seattle.

They are east of I-5, one block south of Jackson. If you get off I-5 at James and go up the hill (away from downtown) to Boron, right, about 4 or 5 blocks right onto 12th, past Jackson, they're on the right (west) side on 12th

PSLAC

c/o Chuck Carlson
18117 - 103rd St. East
Bonney Lake, Wa 98390

